

INSTALLATION METHOD

Art. 45

01.6 ANGLED ROOF DRAIN IN IGOM.EE

- 1 - Apply a layer of primer to the substrate around the area of the drain pipe (approx 600x600 mm), use the quantities indicated by the producer.
- 2 - Torch apply the first layer of waterproofing membrane and cut out the area in correspondence to the drain pipe.
- 3 - Make sure that there is at least a 3° slope. Insert the drain into the hole and mark the length for cutting. If the drain should be used together with a curved pipe fitting, Art. 46 - 47, the drain should be cut making sure that the lower part is 5 mm longer than the top. If the drain is used with Art. 118, the pipe must be cut at a 45° angle (see Fig. A).
- 4 - Heat the previously area of the first layer of waterproofing membrane in correspondence to the hole and press the flange into position.
- 5 - Heat a piece of membrane and spread the melted compound with a trowel in order to cover the ribbed and slotted surface of the flange.
- 6 - Install the second layer of membrane by heating both the previously spread compound as well as the second waterproofing layer and press down strongly.
- 7 - Before installing the curve fitting, apply a bead of sealant, make sure that the fitting fits correctly into the tabs of the curve.
- 8 - Insert the leaf or gravel grate, Art. 44.1.

DESCRIPTION FOR SPECIFICATIONS

Supply and installation of ITALPROFILI® 90° angled drain unit or similar, made from flexible synthetic rubber IGOM.EE. Dimensions: 500 mm long stem, 65 mm in height by 100 mm in width with a flexible flange, complete with 65x100 mm curve fitting with a Ø of 80 or 100 mm for connecting downspout or hopper, with leaf or gravel grate.

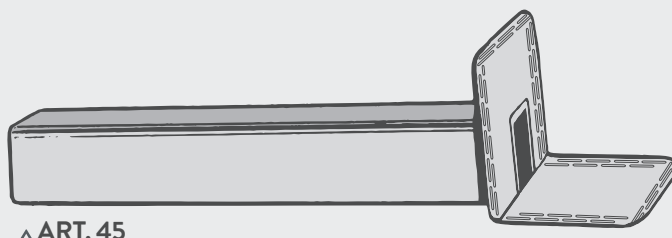

^ ART. 45

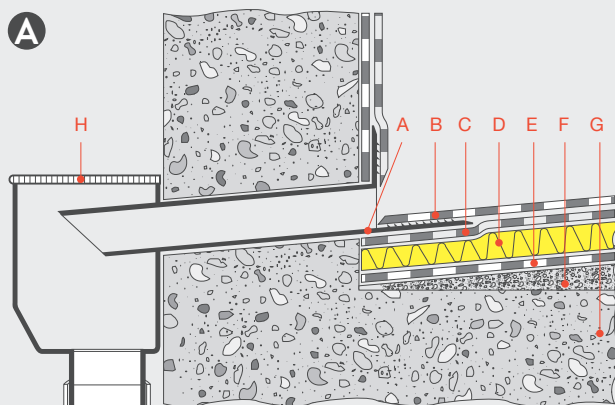

- | | |
|---|--------------------|
| A - Angled roof drain | D - Insulation |
| B - Second layer of bituminous membrane | E - Vapour barrier |
| C - First layer or piece of bituminous membrane | F - Falls |
| | G - Deck |
| | H - Hopper |

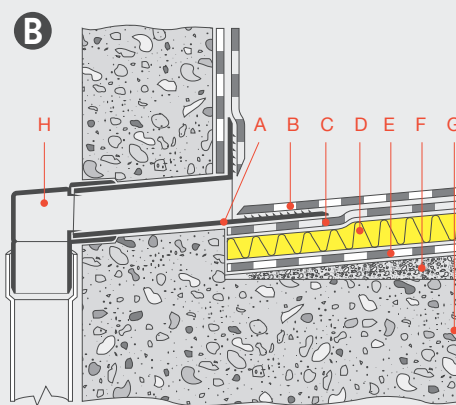

- | | |
|---|--------------------|
| A - Angled roof drain | D - Insulation |
| B - Second layer of bituminous membrane | E - Vapour barrier |
| C - First layer or piece of bituminous membrane | F - Falls |
| | G - Deck |
| | H - Curve |

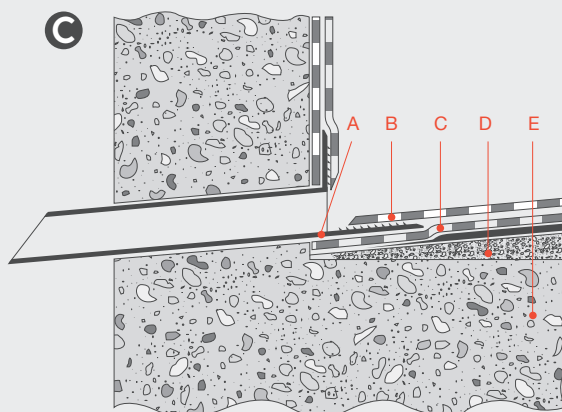

- | |
|---|
| A - Angled roof drain |
| B - Second layer of bituminous membrane |
| C - First layer or piece of bituminous membrane |
| D - Falls |
| E - Deck |